

# LEGACY

## LEGACY SADDLEBAG 16L

### 用户说明书



FURCHTLOS

# INCLUDED 标配

**LEGACY 边包**  
LEGACY Saddlebag



**通用安装带\*4**  
Universal fixation straps\*4



**可拆卸腰带**  
Detachable waist strap

**可拆卸肩带**  
Detachable shoulder strap

**防雨罩**  
Rain cover



# ASSEMBLY AS A SIDE BAG

## 用作边包的安装流程

**⚠️ 温馨提示：**为正确安装LEGACY边包，请提前组装摩托车边架。

Note: For proper assembly of the LEGACY Saddlebag, it's recommended that the motorcycle is fitted with side frames.

**1** 找到您需要放置边包一侧的摩托车相反侧的2个安全安装点。

Locate 2 secure mounting points on the opposite side of the motorcycle of where you want to place the bag.

**2** 将标配的通用安装带九字扣一头绕所选的固定点，九字扣穿过尾部的固定环，穿过后拉紧。

Using the universal fixation strap, pass the G-hook around the mounting point and through the loop on the other end of the strap. Pull tight to ensure the strap is securely attached.

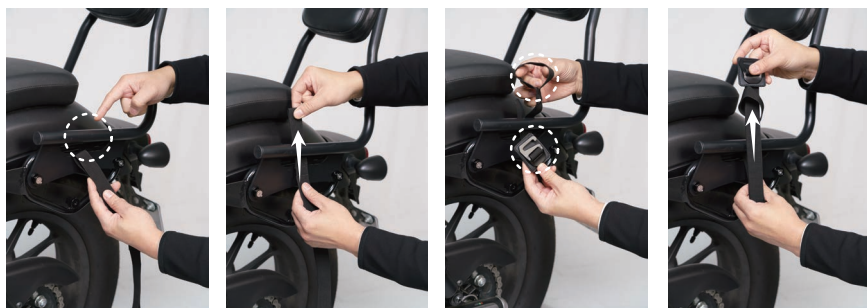

**3** 将通用安装带放摩托车后座上或穿过摩托车后座下，然后将九字扣钩入边包背面的织带环中。

Pass the mounting strap either over or under the pillion seat of the motorcycle, then hook the G hook into the webbing loop in the back of the Saddlebag.



**4** 拉紧通用安装带尾端直至边包处于合适位置，可将拉紧后长出的织带卷叠好塞入松紧环中。

Pull the loose webbing end to tighten the strap. After tightening, the excess webbing length can be folded and tucked inside the elastic band.

**F** 重复步骤2-4，直至2条通用安装带将边包牢固固定于摩托车后座侧方。驾驶前请确保通用安装带已拉紧并将边包牢固固定于摩托车上。

Repeat steps 2-4 so the Saddlebag is secured by two universal fixation straps. Ensure the straps are pulled tight and the bag is securely fastened to the motorcycle before driving.



## ASSEMBLY AS A SEAT BAG 用作后座包的安装流程

可使用标配的4条通用安装带或LEGACY后座包安装垫（单独出售）将LEGACY边包组装至后座。  
The LEGACY Saddlebag can be mounted to the rear seat as a seat bag using the LEGACY Seat Bag Base (sold separately) or the 4 universal fixation straps included with the bag.

使用LEGACY后座包安装垫的安装流程

Assembly with the LEGACY Seat Bag Base

**1** 拆下摩托车座椅，将LEGACY后座包安装垫以logo面朝上放至于所需位置，之后将摩托车座椅重新安装好。

Place the LEGACY Seat Bag Base in the desired position under the rear seat of the bike, keeping the logo facing upwards



- F** 边包正面朝上（皮面上盖朝上）摆放于座椅上方。将LEGACY后座包安装垫的4个九字扣钩入边包边缘上的织带环中或者边包侧面的MOLLE织带环中。

Place the LEGACY Saddlebag on top of the seat. Take the 4 G-hooks of the LEGACY Seat Bag Base and hook them into the webbing loops on the edges of the Saddlebag or into the MOLLE loops on either side of the bag.



- F** 拉动通用安装带尾端以收紧，可将拉紧后长出的安装带卷叠好塞入松紧环中。

Pull the loose webbing ends to tighten the straps and ensure the bag is securely fastened. After tightening, the excess webbing length can be folded and tucked inside the elastic band.



### 使用通用安装带的安装流程

#### Assembly with the Universal Fixation Straps

- F** 将边包正面朝上（皮面上盖朝上）摆放在摩托车后座所需位置。

With the leather flap of the bag facing upwards, place the LEGACY Saddlebag on the rear seat of the motorcycle in the desired position.

- F** 在摩托车两侧各找到2个安全安装点。

Locate 4 secure mounting points, 2 on each side of the motorcycle.

- F** 将标配的通用安装带九字扣一头绕过所选的固定点，九字扣穿过尾部的固定环，穿过后拉紧以确保连接牢固。

Using the universal fixation strap, pass the G-hook around the mounting point and through the loop on the other end of the strap. Pull tight to ensure the strap is securely attached.

- 4** 将通用安装带九字扣钩入边包边缘上的织带环中或者边包侧面的MOLLE织带环中，拉紧通用安装带，直至通用安装带绷直。  
Hook the G hook into the webbing loop on the edge of the Saddlebag or into the MOLLE loops on the side of the bag, then pull the loose webbing end to tighten the strap.

- 5** 可将拉紧后长出的安装带卷叠好塞入松紧环中。  
After tightening, the excess webbing length can be folded and tucked inside the elastic band.

- 6** 重复步骤3-5，直至4条通用安装带将边包牢固固定于后座上。  
Repeat steps 3-5 with the remaining universal fixation straps. Ensure that all 4 straps are pulled tight, and the bag is securely fastened to the rear seat.

## USE OF THE WAIST STRAP

# 腰带的使用方法

- 1** 将九字扣钩入包两侧下部的织带环中。  
Place the G-hooks in the lower webbing loops on either side of the bag.



- 2** 将插扣于腰部中间扣紧，拉动两边织带尾端以收紧。收紧后，可以将多余的安装带折叠并塞入松紧环中。  
Fasten the buckle in the middle and pull the loose webbing ends to tighten the straps. After tightening, the excess webbing length can be folded and tucked inside the elastic band.

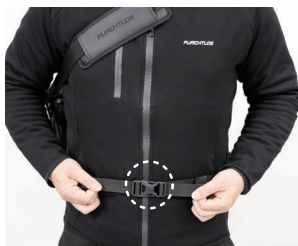

**警告！** 腰带必须系紧以确保正常使用。请勿在腰带松动或未牢固固定的情况下骑摩托车。  
Caution! The waist strap must be well tightened in order to function properly. Do not ride the motorcycle with a waist strap that's loose or not well secured.



# WARNINGS AND GUIDELINES

## 警告和注意事项

### 使用警告 WARNING!

请参阅边包使用说明，使用正确的安装方式！

Please read the user manual carefully and follow the recommended assembly method.

建议在每次操作摩托车之前检查边包是否已连接牢固。

It's recommended to check that the bag is securely attached before each operation of the motorcycle.

切勿在边包未关闭、未连接牢固等可能影响摩托车操作安全的情况下骑行。

Do not drive the motorcycle with a bag that is not fully closed, is not properly secured, or in any other condition that may affect the safe operation of the vehicle.

边包的所有部分，包括通用安装带、防雨罩等配件，不得接触摩托车任何热度过高部件（如排气管等）。

No part of the bag, including the fixation straps, rain cover or other accessories should have close contact with high temperature areas such as the exhaust pipe.

### 清洁与保养注意事项 CLEANING & MAINTENANCE

清洁时只允许使用柔软的纺织布或海绵，清水洗抹。

To clean, wipe with a damp cloth or sponge.

不得使用过高粗糙度的清洁工具、强力清洁剂以及高压清洗机等。

Do not use harsh cleaning agents, chemicals or high pressure cleaners.

当表面材料过长时间暴露在阳光直射下，或受到环境因素的影响时（如雾霾、酸雨等），可能会出现颜色变化或褪色现象。

When the surface material is exposed to direct sunlight for a long time or is affected by environmental factors (such as haze, acid rain, etc.), the color may fade or change.

产品沾染汽油或类似物质，必须立即清洁干净。

If the product is contaminated with gasoline or similar substances it must be cleaned immediately!

FURCHTLOS对清洁保养不当导致的产品损坏和颜色变化不承担任何责任。

FURCHTLOS does not assume any responsibility for product damage and color change caused by improper cleaning and maintenance!



只允许使用柔软的纺织布或  
海绵清水洗抹  
CLEAN WITH A DAMP CLOTH OR  
SOFT SPONGE



禁止使用高压清洗机  
DO NOT PRESSURE WASH



禁止使用过高粗糙度的清洁工具、  
强力清洁剂等  
DO NOT USE CHEMICALS OR HARSH  
CLEANING AGENTS



沾染汽油或类似物质必须  
立即清洁干净  
CLEAN GASOLINE OR OTHER  
SPILLS IMMEDIATELY!



保修登记  
WARRANTY REGISTRATION



微信公众号  
FURCHTLOS WECHAT